



Development & Manufacturing Inc.
Traffic Sign Support Products

WHAT's NEW:

- **REDI-TORQUE Model 280**
- Now **MASH Compliant** and FHWA Accepted under NCHRP350

– A Total Slip Base Sign Support System

- Triangular, Multi-directional Slip Base System
- Product allows for Redi-Torque Bolts to be properly tightened without a torque wrench, while providing necessary holding strength for the post they are supporting.

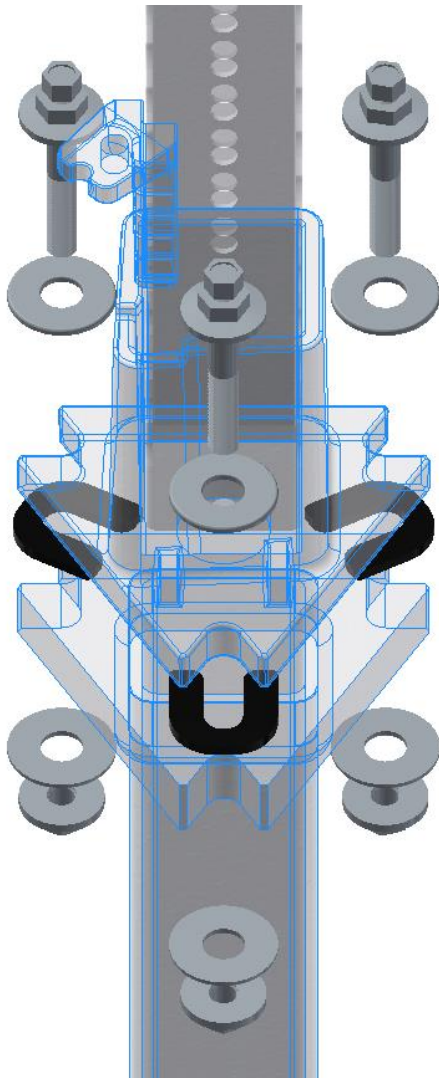

- Ease of reinstallation in high impact areas, without the need for a torques wrench.
- Allows break-away performance – MASH Compliant at both intersecting roadways as well as mainline roadways.
- Product works with omni-directional and bi-directional Slip Base Systems.

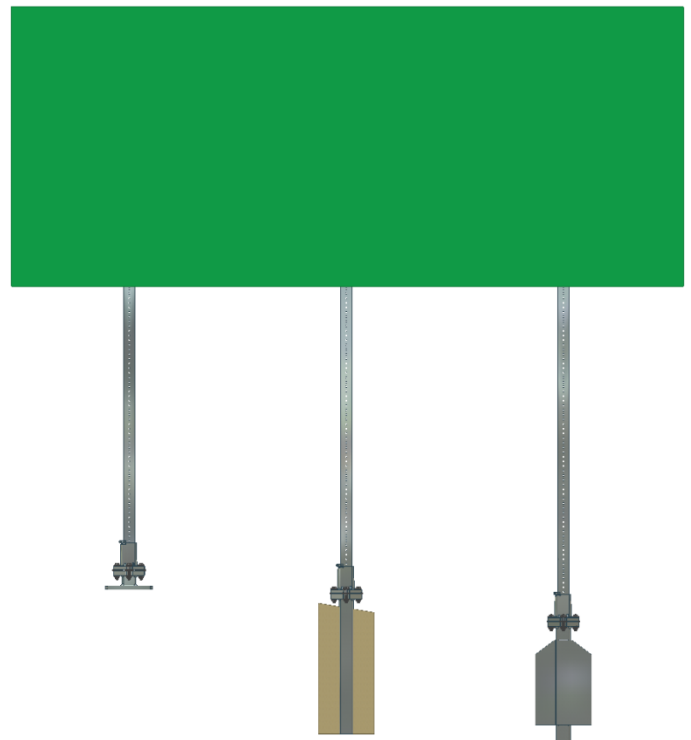

- Be sure to view our [Redi-Torque Brochure](#).
- For additional product information search **Slip Base Products** on our website.